

Traffic Analysis Data

Appendix C

City: 64th and Lavel St

Distance: 400 E at inc ft mi

Desired Speed: 25

Latitude: _____
(optional)

Code (optional): 05131350

Equipment Number: 25781 see diagram

Digit Code (for Manual counters): _____

Installer(s) (initials): Je / Ja

Installer: Clardy Temp: _____

Comments (including unusual Roadway or Trail Condition): _____

Type: Electronic Pneumatic Manual Trail Other

Type of Study: Speed Study

Dir: North South East West

Study Period: _____ Day(s) _____ Week(s)

Standard AM 700-900 _____ to _____ Other Time

Standard Midday 1100-100 _____ to _____ Other Time

Standard PM 400-600 _____ to _____ Other Time

Installed: Date: 5/13/13 Time: 2:15 see diagram

Removed: Date: 5/16 Time: 10:25 see diagram

Diagram:

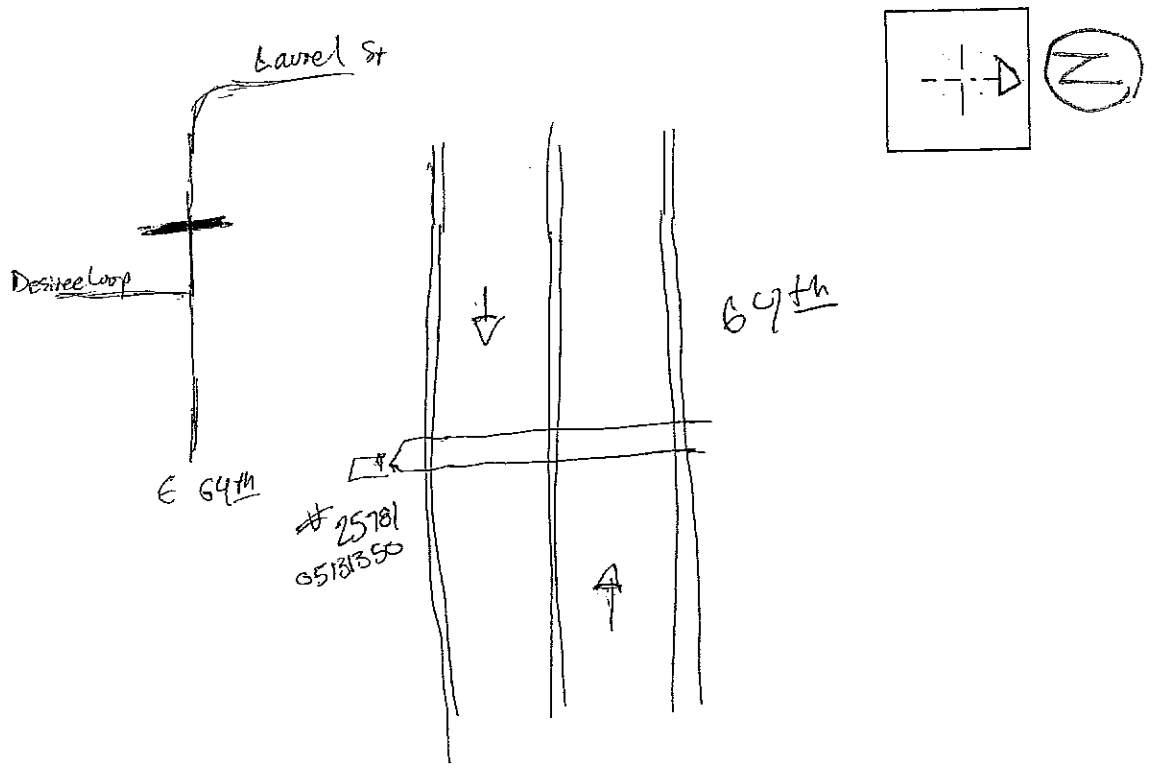

Municipality of Anchorage

Location: 64th and Laurel
 Site Code: 05131350
 Counter: 25781
 05/14/2013-05/15/2013
 Eastbound

Traffic Engineering
 4700 Elmore Road
 Anchorage, Alaska 99519
 Speed Study

Start Time	0 MPH 15 MPH	16 MPH 20 MPH	21 MPH 25 MPH	26 MPH 30 MPH	31 MPH 35 MPH	36 MPH 40 MPH	41 MPH 45 MPH	46 MPH 50 MPH	51 MPH 55 MPH	56 MPH 60 MPH	61 MPH 65 MPH	66 MPH 70 MPH	71 MPH Above	Total
05/15/13	0	1	8	2	0	0	0	0	0	0	0	0	0	11
01:00	1	1	4	4	0	0	0	0	0	0	0	0	0	10
02:00	0	1	2	0	0	0	0	0	0	0	0	0	0	3
03:00	0	0	2	1	1	0	0	0	0	0	0	0	0	4
04:00	1	0	4	0	1	0	0	0	0	0	0	0	0	6
05:00	1	1	1	0	0	0	0	0	0	0	0	0	0	3
06:00	1	1	2	0	0	0	0	0	0	0	0	0	0	4
07:00	2	3	7	6	1	0	0	0	0	0	0	0	0	19
08:00	1	6	7	7	0	0	0	0	0	0	0	0	0	21
09:00	1	2	2	7	0	0	0	0	0	0	0	0	0	12
10:00	0	3	4	9	2	0	0	0	0	0	0	0	0	18
11:00	4	7	14	4	1	0	0	0	0	0	0	0	0	30
12 PM	1	9	12	10	2	1	0	0	0	0	0	0	0	35
13:00	0	8	12	6	1	0	0	0	0	0	0	0	0	27
14:00	3	12	20	2	0	0	0	0	0	0	0	0	0	37
15:00	0	10	18	10	2	1	0	0	0	0	0	0	0	41
16:00	5	9	36	19	4	0	0	0	0	0	0	0	0	73
17:00	3	8	24	31	3	0	1	0	0	0	0	0	0	70
18:00	4	4	27	12	7	1	0	0	0	0	0	0	0	55
19:00	2	5	19	13	2	1	0	0	0	0	0	0	0	42
20:00	0	16	15	11	1	0	0	0	0	0	0	0	0	43
21:00	0	2	8	5	2	0	0	0	0	0	0	0	0	17
22:00	1	6	12	8	0	1	0	0	0	0	0	0	0	28
23:00	0	4	3	4	2	0	0	0	0	0	0	0	0	13
Total	31	119	263	171	32	5	1	0	0	0	0	0	0	622

Statistics 85th Percentile : 28 MPH

2010 INTERSECTION APPROACH VOLUMES

CNT	STREET		COUNT DATE	VEHICLE VOLUMES					
	NORTH / SOUTH	EAST / WEST		NORTH	SOUTH	EAST	WEST	TOTAL	AADT
1	A	003	6/9/2010	9565	-	-	8008	17573	14900
2	A	004	5/18/2010	10968	-	4963	-	15931	14500
3	Admiralty Bay	Perenosa Bay	6/30/2010	451	1297	761	273	2782	2400
4	Airport Heights	005	8/4/2010	7576	4697	28664	28886	69823	60200
5	Airport Heights	016	6/16/2010	363	1670	1128	286	3447	3000
6	Amber Bay	Perenosa Bay	6/30/2010	-	80	368	491	939	800
7	Anderson	Harvard	7/15/2010	-	216	262	463	941	800
8	Austin	Lynnwood	7/1/2010	1149	2617	417	384	4567	3700
9	B	005	7/21/2010	1102	627	-	15756	17485	14800
10	Bayshore	Admiralty Bay	6/30/2010	615	6038	3780	271	10704	9000
11	Bettles Bay	Eshamy Bay	5/25/2010	276	354	-	744	1374	1100
12	Boniface	004	2/4/2010	9996	10699	1109	1031	22835	22700
13	Boniface	Glenn SR at Boniface	8/4/2010	12127	13552	4002	-	29681	25600
14	Brandon	Cross	6/2/2010	171	1191	1517	-	2879	2600
15	Brien	Barry	6/30/2010	80	-	111	76	267	200
16	Buffalo	142	6/30/2010	1253	1434	-	214	2901	2300
17	C	004	5/18/2010	-	14389	4570	1502	20461	17700
18	C	100	9/23/2010	4365	4551	126	1724	10766	10800
19	Caravelle	Hunter	7/14/2010	412	953	1114	106	2585	2200
20	Carriage	064	7/14/2010	412	267	652	203	1534	1400
21	Chain Of Rock	Meadow Creek	5/26/2010	781	591	1438	522	3332	2900
22	Checkmate	Wesleyan	7/15/2010	1794	1123	848	-	3765	3400
23	Clare	O'Malley	6/30/2010	17	345	5961	5810	12133	9700
24	Cordova	004	5/19/2010	1474	895	7004	-	9373	8300
25	Cordova	005	5/19/2010	2094	1218	-	21959	25271	22500
26	Cordova	006	5/19/2010	3010	2023	17310	-	22343	19900
27	Cottonwood	Vassar	5/26/2010	934	731	93	1079	2837	2500
28	Dale	042	7/21/2010	1400	1766	1216	1541	5923	5300
29	Denali	Fireweed	8/4/2010	2668	-	7766	4966	15400	13400
30	Dimond Hook	084	5/25/2010	1710	486	-	1976	4172	3900
31	Dimond Hook	084	5/26/2010	1642	457	-	1975	4074	3800
32	E	003	5/19/2010	2285	2090	786	4410	9571	8300
33	E	004	5/19/2010	2992	-	4556	2835	10383	9000
34	E	005	5/27/2010	3499	-	-	18335	21834	19500
35	E	006	5/19/2010	3549	-	13186	-	16735	14900
36	E	007	5/27/2010	4187	-	1948	2100	8235	7100
37	Elmore	068	7/15/2010	7765	8472	1384	-	17621	15700
38	Elmore	Abbott	7/15/2010	165	6916	7794	6059	20934	18600
39	Elmore	Dowling	7/15/2010	8494	12339	5938	-	26771	23800
40	Elmore	Lore	7/15/2010	6721	7799	1417	-	15937	14300
41	Elmore	Providence	7/15/2010	6614	-	8452	2381	17447	15700
42	Elmore	Tudor	7/15/2010	13075	5295	16663	24680	59713	53800
43	F	004	5/19/2010	619	-	3338	1766	5723	5100
44	F	005	5/19/2010	-	-	-	23851	23851	21200
45	F	006	5/19/2010	618	-	12565	-	13183	11700
46	F	007	5/19/2010	837	296	1266	1575	3974	3500
47	G	004	5/20/2010	-	1633	4656	1743	8032	7200
48	G	005	5/19/2010	-	2455	-	30728	33183	29600
49	G	007	5/19/2010	2515	2943	10942	-	16400	14600
50	Gambell	004	5/18/2010	-	5824	9921	-	15745	13900

2008 INTERSECTION APPROACH VOLUMES

CNT	STREET		COUNT DATE	VEHICLE VOLUMES					
	NORTH / SOUTH	EAST / WEST		NORTH	SOUTH	EAST	WEST	TOTAL	AADT
1	Amber Bay	Perenosa Bay	05/21/08	-	85	324	534	943	800
2	Arctic	Chugach Way	06/11/08	7421	8272	2263	-	17956	15400
3	Arctic	027	06/11/08	5949	7707	2099	693	16448	14100
4	Arctic	030	06/11/08	7330	6813	1188	-	15331	13200
5	Arctic	031	06/11/08	7479	6715	-	756	14950	12900
6	Arctic	032	06/11/08	7217	6255	-	1457	14929	12800
7	Arctic	034	06/11/08	7119	6964	-	923	15006	12900
8	Arctic	041	06/11/08	7435	7271	-	1041	15747	13500
9	Arctic	International Airport	06/26/08	11806	6795	16516	11809	46926	40500
10	Arctic	Northern Lights	06/26/08	6500	5327	-	23056	34883	30100
11	Arctic	Potter	06/11/08	6742	6687	319	2361	16109	13900
12	Austin	Lynnwood	06/10/08	848	1326	557	262	2993	2400
13	Bainbridge	Huffman	07/15/08	185	476	1373	961	2995	2500
14	Bartlett High Access	North Muldoon	06/25/08	-	558	3427	4904	8889	7700
15	Bayshore	Admiralty Bay	05/21/08	2455	1128	215	2388	6186	5300
16	Birch	Abbott	05/14/08	1840	-	3939	2581	8360	7500
17	Birch	Huffman	07/15/08	1062	1219	-	708	2989	2500
18	Birch Lane	First	06/03/08	256	308	84	124	772	700
19	Boniface	Caribou	07/16/08	11425	11581	2167	2393	27566	23800
20	Boniface	Perry	07/15/08	755	-	12115	12397	25267	22400
21	Bragaw	016	06/18/08	10339	8126	949	839	20253	17500
22	Bragaw	San Jeronmino	06/18/08	7592	6830	994	1551	16967	14600
23	Brayton	Lore	07/15/08	11417	-	-	2715	14132	12300
24	Brien	Barry	05/06/08	62	-	170	93	325	300
25	Buffalo	142	05/14/08	1133	1383	-	228	2744	2500
26	C	O'Malley EB (West Side)	06/10/08	7683	7266	2773	-	17722	14700
27	C	O'Malley WB (East Side)	06/09/08	5537	6098	-	4679	16314	14100
28	C	092	06/25/08	4748	5012	418	1759	11937	9700
29	C	Klatt	06/25/08	4328	6827	281	5786	17222	14000
30	Carriage	064	05/13/08	569	142	508	-	1219	1100
31	Cedar	Bluff	06/03/08	195	-	1795	1069	3059	1900
32	Chain of Rock	Baronoff	06/03/08	407	1291	167	480	2345	2000
33	Checkmate	Tudor	07/16/08	-	1493	24690	21924	48107	46800
34	Checkmate	Wesleyan	06/17/08	1398	742	2230	-	4370	4400
35	Clare	O'Malley	05/15/08	27	578	5705	5288	11598	10100
36	Crest View	War Admiral	06/03/08	549	136	522	854	2061	1800
37	Dale	042	06/19/08	1484	1578	1138	850	5050	4500
38	Dawson	Northern Lights	06/11/08	935	-	-	31814	32749	29400
39	Donna	006	05/07/08	519	467	869	-	1855	1900
40	Eagle	003	07/16/08	450	1290	-	7606	9346	9200
41	Eagle	Fireweed	06/17/08	863	1383	8535	4300	15081	12700
42	Eagle	Northern Lights	06/10/08	-	2216	-	25276	27492	24800
43	Eagle River Lane	War Admiral	06/04/08	521	166	378	416	1481	1300
44	Eagle River Loop	Meadow Creek	06/04/08	521	166	378	462	1527	1300
45	Edward	006	05/07/08	802	-	859	829	2490	2500
46	Edward	Debarr	06/18/08	-	2195	13080	12468	27743	23900
47	Elmore	084	07/16/08	5714	5178	1055	-	11947	11700
48	Elmore	Lore	05/13/08	5346	5672	1252	-	12270	10400
49	Elmore	Providence	07/16/08	9419	-	6025	1467	16911	16600
50	Eureka	Benson	06/17/08	-	401	21817	-	22218	19600

[Excel Download](#)



[Map](#)

**Municipality of Anchorage
Incident Report**

Date Range: 1/1/2011 - 12/31/2011

Intersection Related: All

Location: Street: CARRIAGE DRIVE, ANCHORAGE EAST 64TH AVENUE, ANCHORAGE

Collision Events

Date	Time	Dist	Dir	Street	Cross Reference	1st Seq Events Location	1st Seq Events Type	Unit No.	2nd Sequence of Events	Vehicle Circumstances	Vehicle Action	Human Circum 1	Human Circum 2	Alcohol / Drugs Suspected	Int Related
08/27/2011	AM 09:25	100 ft.	S	CARRIAGE DRIVE, ANCHORAGE	EAST 64TH AVENUE, ANCHORAGE	Roadway	Parked vehicle	1				Unk			Not Related
08/27/2011	AM 09:25	100 ft.	S	CARRIAGE DRIVE, ANCHORAGE	EAST 64TH AVENUE, ANCHORAGE	Roadway	Parked vehicle	2		None	Parked	No improper driving		None	Not Related

Date	Time	Dir	Street	Cross Reference	1st Seq Events Location	1st Seq Events Type	Lighting	Weather	Roadway Surface	Unit No.	Dir. of Travel	Traffic Control	Vehicle Action	Occupant Type	Injury Status	Int Related
3/28/2002	AM 07:34		LAUREL STREET	EAST 64TH AVENUE	Roadway	Vehicle - angle	Daylight	Clear	Ice	1	West	No controls	Skidding	Driver	None	Related
3/28/2002	AM 07:34		LAUREL STREET	EAST 64TH AVENUE	Roadway	Vehicle - angle	Daylight	Clear	Ice	2	South	No controls	Turning left	Driver	None	Related
11/12/2003	AM 07:45		EAST 64TH AVENUE	LAUREL STREET	Roadway	Vehicle - angle	Dark, lighted roadway	Snow	Ice	1	West	No controls	Skidding	Driver	None	Not Related
11/12/2003	AM 07:45		EAST 64TH AVENUE	LAUREL STREET	Roadway	Vehicle - angle	Dark, lighted roadway	Snow	Ice	2	South	No controls	Turning left	Driver	None	Not Related
12/28/2003	AM 10:00		LAUREL STREET	EAST 64TH AVENUE	Roadway	Vehicle - angle	Twilight	Cloudy	Ice	1	West	No controls	Skidding	Driver	None	Not Related
12/28/2003	AM 10:00		LAUREL STREET	EAST 64TH AVENUE	Roadway	Vehicle - angle	Twilight	Cloudy	Ice	2	South	No controls	Straight ahead	Driver	None	Not Related
1/2/2004	AM 01:41	E	EAST 64TH AVENUE	LAUREL STREET	Unk	Other fixed object	Dark, lighted roadway	Clear	Ice	1	East	No controls	Skidding	Driver	Non-incapacitating	Not Related
11/13/2005	PM 03:28		LAUREL STREET	EAST 64TH AVENUE	Roadway	Utility pole	Daylight	Cloudy	Ice	1	South	No controls	Straight ahead	Driver	None	Related
1/21/2007	PM 01:31		EAST 64TH AVENUE	LAUREL STREET	Roadway	Sideswipe	Daylight	Cloudy	Snow	1	West	No controls	Skidding	Driver	Unk	Related
1/21/2007	PM 01:31		EAST 64TH AVENUE	LAUREL STREET	Roadway	Sideswipe	Daylight	Cloudy	Snow	1	West	No controls	Skidding	Passenger	None	Related
1/21/2007	PM 01:31		EAST 64TH AVENUE	LAUREL STREET	Roadway	Sideswipe	Daylight	Cloudy	Snow	1	West	No controls	Skidding	Passenger	None	Related
1/21/2007	PM 01:31		EAST 64TH AVENUE	LAUREL STREET	Roadway	Sideswipe	Daylight	Cloudy	Snow	2	South	No controls	Turning left	Driver	Non-incapacitating	Related
9/8/2009	AM 08:38		LAUREL STREET	EAST 64TH AVENUE	Roadway	Vehicle - angle	Daylight	Cloudy	Dry	1	South	No controls	Turning left	Driver	None	Not Related
9/8/2009	AM 08:38		LAUREL STREET	EAST 64TH AVENUE	Roadway	Vehicle - angle	Daylight	Cloudy	Dry	2	West	No controls	Turning right	Driver	None	Not Related
12/5/2009	PM 01:13	E	EAST 64TH AVENUE	LAUREL STREET	Roadway	Parked vehicle	Daylight	Cloudy	Ice	1	East	No controls	Straight ahead	Driver	None	Not Related
12/5/2009	PM 01:13	E	EAST 64TH AVENUE	LAUREL STREET	Roadway	Parked vehicle	Daylight	Cloudy	Ice	2	West	No controls	Parked	Driver	None	Not Related
3/19/2010	PM 05:26		LAUREL STREET	EAST 64TH AVENUE	Roadway	Vehicle - angle	Daylight	Clear	Dry	1	South	No controls	Turning left	Driver	None	Not Related
3/19/2010	PM 05:26		LAUREL STREET	EAST 64TH AVENUE	Roadway	Vehicle - angle	Daylight	Clear	Dry	1	South	No controls	Turning left	Passenger	None	Not Related
3/19/2010	PM 05:26		LAUREL STREET	EAST 64TH AVENUE	Roadway	Vehicle - angle	Daylight	Clear	Dry	2	West	No controls	Turning right	Driver	None	Not Related
1/18/2011	AM 11:31		EAST 64TH AVENUE	LAUREL STREET	Roadway	Sideswipe	Daylight	Clear	Ice	1	East	No controls	Straight ahead	Driver	None	Related
1/18/2011	AM 11:31		EAST 64TH AVENUE	LAUREL STREET	Roadway	Sideswipe	Daylight	Clear	Ice	2	West	No controls	Turning right	Driver	None	Related
7/9/2011	AM 09:23	N	LAUREL STREET	EAST 64TH AVENUE	Outside traffic way	Parked vehicle	Daylight	Cloudy	Dry	1	West	No controls	Backing	Driver	None	Not Related
7/9/2011	AM 09:23	N	LAUREL STREET	EAST 64TH AVENUE	Outside traffic way	Parked vehicle	Daylight	Cloudy	Dry	2	South	No controls	Parked	No Driver	None	Not Related
2/21/2005	AM 03:07		DESIREE LOOP	EAST 64TH AVENUE	Roadway	Ditch	Dark, roadway not lighted	Cloudy	Ice	1	South	Stop sign	Skidding	Driver	None	Related
5/26/2005	PM 07:36		ROSE HIP CIRCLE	EAST 64TH AVENUE	Roadway	Vehicle - angle	Daylight	Cloudy	Dry	1	South	Stop sign	Straight ahead	Driver	Possible	Related
5/26/2005	PM 07:36		ROSE HIP CIRCLE	EAST 64TH AVENUE	Roadway	Vehicle - angle	Daylight	Cloudy	Dry	2	East	Unk	Straight ahead	Driver	Possible	Related
3/14/2011	PM 02:28		ROSE HIP CIRCLE	EAST 64TH AVENUE	Roadway	Vehicle - angle	Daylight	Clear	Ice	1	North	No controls	Turning left	Driver	None	Related
3/14/2011	PM 02:28		ROSE HIP CIRCLE	EAST 64TH AVENUE	Roadway	Vehicle - angle	Daylight	Clear	Ice	2	South	Stop sign	Unk	Driver	None	Related
3/14/2011	PM 02:28		ROSE HIP CIRCLE	EAST 64TH AVENUE	Roadway	Vehicle - angle	Daylight	Clear	Ice	2	South	Stop sign	Unk	Passenger	None	Related
1/15/2011	PM 12:08	S	DESIREE LOOP	EAST 64TH AVENUE	Roadway	Vehicle - angle	Daylight	Clear	Ice	1	West	No controls	Backing	Driver	None	Not Related
1/15/2011	PM 12:08	S	DESIREE LOOP	EAST 64TH AVENUE	Roadway	Vehicle - angle	Daylight	Clear	Ice	2	South	No controls	Straight ahead	Driver	None	Not Related
5/26/2005	PM 07:36		ROSE HIP CIRCLE	EAST 64TH AVENUE	Roadway	Vehicle - angle	Daylight	Cloudy	Dry	1	South	Stop sign	Straight ahead	Driver	Possible	Related
5/26/2005	PM 07:36		ROSE HIP CIRCLE	EAST 64TH AVENUE	Roadway	Vehicle - angle	Daylight	Cloudy	Dry	2	East	Unk	Straight ahead	Driver	Possible	Related
3/14/2011	PM 02:28		ROSE HIP CIRCLE	EAST 64TH AVENUE	Roadway	Vehicle - angle	Daylight	Clear	Ice	1	North	No controls	Turning left	Driver	None	Related
3/14/2011	PM 02:28		ROSE HIP CIRCLE	EAST 64TH AVENUE	Roadway	Vehicle - angle	Daylight	Clear	Ice	2	South	Stop sign	Unk	Driver	None	Related
3/14/2011	PM 02:28		ROSE HIP CIRCLE	EAST 64TH AVENUE	Roadway	Vehicle - angle	Daylight	Clear	Ice	2	South	Stop sign	Unk	Passenger	None	Related
8/27/2011	AM 09:25	S	CARRIAGE DRIVE	EAST 64TH AVENUE	Roadway	Parked vehicle	Daylight	Clear	Dry	1				Driver	None	Not Related
8/27/2011	AM 09:25	S	CARRIAGE DRIVE	EAST 64TH AVENUE	Roadway	Parked vehicle	Daylight	Clear	Dry	2	South	No controls	Parked	No Driver	None	Not Related
8/27/2011	AM 09:25	S	CARRIAGE DRIVE	EAST 64TH AVENUE	Roadway	Parked vehicle	Daylight	Clear	Dry	1				Driver	None	Not Related
8/27/2011	AM 09:25	S	CARRIAGE DRIVE	EAST 64TH AVENUE	Roadway	Parked vehicle	Daylight	Clear	Dry	2	South	No controls	Parked	No Driver	None	Not Related
8/27/2011	AM 09:25	S	CARRIAGE DRIVE	EAST 64TH AVENUE	Roadway	Parked vehicle	Daylight	Clear	Dry	1				Driver	None	Not Related
8/27/2011	AM 09:25	S	CARRIAGE DRIVE	EAST 64TH AVENUE	Roadway	Parked vehicle	Daylight	Clear	Dry	2	South	No controls	Parked	No Driver	None	Not Related
1/9/2007	PM 12:32	E	NORM DRIVE	EAST 64TH AVENUE	Roadway	Sideswipe	Daylight	Clear	Snow	1	West	No controls	Straight ahead	Driver	None	Related
1/9/2007	PM 12:32	E	NORM DRIVE	EAST 64TH AVENUE	Roadway	Sideswipe	Daylight	Clear	Snow	1	West	No controls	Straight ahead	Passenger	None	Related
1/9/2007	PM 12:32	E	NORM DRIVE	EAST 64TH AVENUE	Roadway	Sideswipe	Daylight	Clear	Snow	2	East	No controls	Straight ahead	Driver	None	Related
5/12/2008	PM 04:00		NORM DRIVE	EAST 64TH AVENUE	Roadway	Vehicle - rear end	Daylight	Cloudy	Dry	1	South	Stop sign	Slowing	Driver	None	Related
5/12/2008	PM 04:00		NORM DRIVE	EAST 64TH AVENUE	Roadway	Vehicle - rear end	Daylight	Cloudy	Dry	2	South	Stop sign	Stopped	Driver	Possible	Related

Collision Events

Accident along 64th between Laurel & Norm (2008 - 2010)

Date: 1/1/2008 - 12/31/2010

Number	Date	Time	Dir	Street	Cross Reference	1st Seq Events Location	1st Seq Events Type	Unit No.	Vehicle Action	Human Circum 1	Human Circum 2	Alcohol / Drugs Suspected	Int Related
1	5/12/2008	PM 04:00		NORM DRIVE	EAST 64TH AVENUE	Roadway	Vehicle - rear end	1	Slowing	Driver inattention		None	Related
	5/12/2008	PM 04:00		NORM DRIVE	EAST 64TH AVENUE	Roadway	Vehicle - rear end	2	Stopped	No improper driving		None	Related
2	9/8/2009	AM 08:38		LAUREL STREET	EAST 64TH AVENUE	Roadway	Vehicle - angle	1	Turning left	Wrong side/way		None	Not Related
	9/8/2009	AM 08:38		LAUREL STREET	EAST 64TH AVENUE	Roadway	Vehicle - angle	2	Turning right	No improper driving		None	Not Related
3	12/5/2009	PM 01:13	E	EAST 64TH AVENUE	LAUREL STREET	Roadway	Parked vehicle	1	Straight ahead	Improper lane usage/change	Unsafe speed	None	Not Related
	12/5/2009	PM 01:13	E	EAST 64TH AVENUE	LAUREL STREET	Roadway	Parked vehicle	2	Parked	No improper driving		Unk	Not Related
4	3/19/2010	PM 05:26		LAUREL STREET	EAST 64TH AVENUE	Roadway	Vehicle - angle	1	Turning left	Wrong side/way		None	Not Related
	3/19/2010	PM 05:26		LAUREL STREET	EAST 64TH AVENUE	Roadway	Vehicle - angle	2	Turning right	No improper driving		None	Not Related